

## SCHEDULE

to EC-Type Examination Certificate KEMA 01ATEX2246

### (1) EC-TYPE EXAMINATION CERTIFICATE

- (2) Equipment or protective system intended for use in potentially explosive atmospheres - Directive 94/9/EC
- (3) EC-Type Examination Certificate Number: **KEMA 01ATEX2246**
- (4) Equipment or protective system: **Control units type SEL**
- (5) Manufacturer: **CO.SI.ME. S.R.L**
- (6) Address: **Via Asiago, 51, 20128 Milan, Italy**
- (7) This equipment or protective system and any acceptable variation thereto is specified in the schedule to this certificate and the documents therein referred to.
- (8) KEMA Quality B.V., notified body number 0344 in accordance with Article 9 of the Council Directive 94/9/EC of 23 March 1994, certifies that this equipment or protective system has been found to comply with the Essential Health and Safety Requirements relating to the design and construction of equipment and protective systems intended for use in potentially explosive atmospheres given in Annex II to the directive.
- (9) The examination and test results are recorded in confidential report no. 2016574.
- (10) Compliance with the Essential Health and Safety Requirements has been assured by compliance with:
- EN 50014 : 1997    EN 50018 : 2000    EN 50281-1-1 : 1998**
- (11) If the sign "X" is placed after the certificate number, it indicates that the equipment or protective system is subject to special conditions for safe use specified in the schedule to this certificate.
- (12) This EC-Type Examination Certificate relates only to the design, examination and tests of the specified equipment or protective system according to the Directive 94/9/EC. Further requirements of the directive apply to the manufacturing process and supply of this equipment or protective system. These are not covered by this certificate.
- (13) The marking of the equipment or protective system shall include the following:

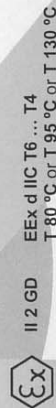

Arnhem, 12 December 2003  
KEMA Quality B.V.

C.G. van Es  
Certification Manager

\* This Certificate may only be reproduced in its entirety and without any change

KEMA Quality B.V.  
Utrechtseweg 310, 6812 AR Arnhem, The Netherlands  
P.O. Box 5165, 6802 ED Arnhem, The Netherlands  
Telephone +31 26 3 56 20 08, Telefax +31 26 3 52 58 00



ACCREDITED BY THE  
DUTCH COUNCIL FOR  
ACCREDITATION

(13)  
(14)

(15) **Description**

Control unit type SEL consists of a light alloy body and a light alloy cover. The control unit can be provided with switching and pushing devices.

Standard ambient temperature range: -20 °C ... +40 °C.  
Special ambient temperature range: -50 °C ... +80 °C.  
Protection degree: IP 66 according to EN 60529

The relation between the ambient temperature, the temperature class and the maximum surface temperature T is as follows:

Maximum ambient temperature	Temperature class	Maximum surface Temperature T
40 °C	T6	80 °C
60 °C	T5	95 °C
80 °C	T4	130 °C

**Electrical data**

Rated voltage..... max. 690 Vac – 110 Vdc  
Rated current..... max. 32 A  
Frequency..... 50 ... 60 Hz

**Installation instructions**

For ambient temperatures between 40 °C and 60 °C, cables and cable entry devices suitable for a temperature of at least 95 °C shall be used.  
For ambient temperatures between 60 °C and 80 °C, cables and cable entry devices suitable for a temperature of at least 115 °C shall be used.

The cable entry devices and blanking elements shall be of a certified flameproof type, suitable for the conditions of use and correctly installed. For combustible dust applications, the cable entry device and blanking elements shall be in type of explosion protection increased safety "e" or flameproof enclosure "d" and shall have an IP 6X rating according to EN 60529.

For connection of an external and internal earthing or bonding conductor a cable lug shall be used. The conductor shall be mounted so that it is secured against loosening and twisting and that the contact pressure is permanently maintained.

**Routine tests**

Routine tests according to Clause 16 of EN 50018 are not required since the type test has been made at a static pressure of four times the reference pressure.

(16)

**Report**

KEMA No. 2016574

(17)

**Special conditions for safe use**

None.

(18)

**Essential Health and Safety Requirements**

Covered by the standards listed at (9).

**SCHEDULE**

to EC-Type Examination Certificate KEMA 01ATEX2246

(13)  
(14)

(19) **Test documentation**

- |                                       |       |            |
|---------------------------------------|-------|------------|
| 1. Technical Note AC10029TN (3 pages) | dated | 08.08.2001 |
| 2. Drawing No. AC10029                |       | 23.06.2001 |

CO.SI.ME S.r.l. Via Asiago N° 51 - 20128 MILAN - ITALY  
Tel: +39 02 25 76 510 - Fax: +39 02 25 25 2965 - co.sime@hn.it

**Dichiarazione CE di conformità**  
**EC Declaration of conformity**



CO.SI.ME. Srl  
Via Asiago, 51  
20128 Milan  
ITALY

Noi  
We

Dichiariamo sotto la nostra esclusiva responsabilità che i prodotti :  
*Declare under our sole responsibility that the products :*

Apparecchi tipo **SEL**  
*Apparatuses type SEL*

ai quali questo attestato si riferisce sono conformi a :

- Direttiva ATEX 94/9/CE : apparecchi e sistemi di protezione destinati ad essere utilizzati in atmosfera potenzialmente esplosiva.
  - Direttiva 89/336/CE : compatibilità elettromagnetica
- to which this attestation relates are in conformity with :*
- *Directive ATEX 94/9/EC : equipment and protective systems intended for use in potentially explosive atmospheres*
  - *Directive 89/336/EC : Electromagnetic compatibility*

e sono costruiti in accordo alle seguenti Norme :  
*and they are manufactured in conformity with the following Standards :*

- EN 50014 : 1997 + A1/A2 : 1999
- EN 50018 : 2000
- EN 50281-1-1 : 1998
- EN 60529 : 1991
- EN 60947-5-1: 1997
- EN 60947-3 : 1999

Certificato di esame del prodotto :  
*Examination certificate of the product :*

KEMA 01 ATEX 2246

Nome dell' Organismo incaricato della sorveglianza ai fini della qualità : **CESI**  
*Name of Body involved in the production quality system surveillance :*

N° dell' Organismo notificato  
*N° of the notified Body*

0722

Milano, 12 december 2003  
(luogo e data)  
*(place and date of issue)*

Ing. Massimo Tonetti  
(nome e firma o timbratura equivalente della persona autorizzata)  
*(name and signature or equivalent marking of authorised person)*

Documento / Document			IU-SEL		
N° Pagine / Sheet N°			1	di / of	1
REV	0	1	2	3	4
DATA	08/08/01				
EXE by	M.T.				
CHK by	F.C.				
APP by	M.T.				

**Manipolatori, interruttori e pulsanti SEL**  
**Switches and push buttons SEL**

Assistenza tecnica - Technical support  
 +39 02 25 76 510  
 +39 02 25 52 365

**Questo documento non può essere modificato senza l'approvazione dell' Organismo Notificato.**  
*This document cannot be modified without approval of the Notified Body.*



**1 Istruzioni di sicurezza**

Queste istruzioni devono essere conservate in luogo sicuro per future consultazioni. Per personale esperto e qualificato in accordo alle Leggi nazionali, in accordo alle relative Norme e, dove applicabile, in accordo alla IEC-79-17 per costruzioni elettriche per atmosfere potenzialmente esplosive. Questa costruzione elettrica deve essere installata solo per l'utilizzo per il quale è destinata. Non è ammessa alcuna modifica alla costruzione elettrica. Rispettare le caratteristiche elettriche indicate sulla costruzione. Questa costruzione elettrica non è adatta per l'utilizzo in zona 0 e zona 20

**1 Safety instructions**

*These operating instructions must be kept in safe place for later consultations. For skilled and experienced personnel according with the national laws, the relevant standards and, where applicable, according with IEC-79-17 standards for electrical apparatus for potentially explosive atmospheres. This electrical apparatus must be used for its intended purpose. No modifications to the electrical apparatus shall be allowed. Observe the electrical features indicated on the apparatus. This electrical apparatus is not suitable to be installed in zone 0 and zone 20*

**Conformità alle Norme**

La costruzione elettrica è conforme a Norme EN 50014, EN 50018, EN 50281-1-1 ed alla Direttiva 94/9/EC. Costruzione per zona 1, zona 2, zona 21 e zona 22 (IEC 79-14 / CEI EN 60079-14).

**Conformity with standards**

*The electrical apparatus meet the requirements of EN 50014, EN 50018, EN 50281-1-1 and Directive 94/9/EC. Electrical apparatus for zone 1, zone 2, zone 21 and zone 22 (IEC 79-14 / CEI EN 60079-14).*

**3 Dati Tecnici - Technical data**

Modo di protezione : Protection mode :	EEx d IIC T6÷T4 (EN 50014) T80°C÷T130°C (EN 50281-1-1)	II 2 G D (Directive 94/9/EC)
Grado di protezione : Protection degree :	IP 66 (EN 60529)	Peso [Kg] : 1,7 Weight [Kg] :
Certificato di esame CE del tipo : EC-type examination certificate :	KEMA 01ATEX2246	Coppia serraggio viti di chiusura [Nm] : 15 Fastening screws torque [Nm] :
Temperatura ambiente [°C] : -20 ÷ +40 Ambient temperature [°C] :	Temperatura ambiente speciale [°C] : -50 ÷ +80 Special ambient temperature [°C] :	Temperatura immagazzinaggio [°C] : -50 ÷ +80 Storage temperature [°C] :
Tensione nom. Isol. Ui : max. 690 Vac Rated insul. voltage Ui :	Corrente nominale [A] : max. 32 Rated current [A] :	Frequenza [Hz] : 50 ÷ 60 Frequency [Hz] :
Tensione nominale Ue : max. 500 Vac Rated voltage Ue : max. 110 Vdc		
Entrate di cavo : EEx d IIC (EN 50018) Cable entry :	Grado di protezione minimo IP 66 Minimum protection degree IP 66	Altre caratteristiche elettriche : vedi targa Other electrical features : see plate

**4 Installazione** : La costruzione elettrica può essere installata solo se esente da danni. Rispettare le Norme nazionali in materia di costruzioni elettriche per atmosfera potenzialmente esplosiva. Utilizzare solo accessori forniti da CO.SI.ME. per l'installazione della costruzione elettrica. Prima di chiudere la custodia verificare che i giunti siano lubrificati ed esenti da corpi estranei e difetti. Sostituire la guarnizione durante la manutenzione periodica dell'apparecchio. Le entrate di cavo con grado di protezione inferiore a IP 66 riducono il grado di protezione dell'intero apparecchio. Cavo di alimentazione richiesto per temperatura ambiente +60°C : temperatura di esercizio >= +95°C. Cavo di alimentazione richiesto per temperatura ambiente +80°C : temperatura di esercizio >= +115°C.

**4 Installation** : The electrical apparatus shall be installed in absence of damages. Observe the national standards concerning electrical apparatus for potentially explosive atmospheres. Utilize the installation accessories supplied by CO.SI.ME. Before closing the enclosure, check that joints were lubricated and free of foreign matters and deformations. Replace gasket during periodical maintenance. Cable entries with protection degree lower than IP 66 reduce the whole protection of the apparatus. Conductor required for ambient temperature +60°C : operating temperature >= +95°C. Conductor required for ambient temperature +80°C : operating temperature >= +115°C.



**5 Manutenzione** : Le riparazioni o sostituzioni di parti danneggiate o non funzionanti possono essere effettuate solo da personale esperto e qualificato con parti di ricambio fornite da CO.SI.ME. Le riparazioni che influiscono sul modo di protezione antideflagrante possono essere effettuate solo da CO.SI.ME.

**5 Maintenance** : Repairs and replacements of damaged or faulty parts must be carried out by skilled and experienced personnel with spare parts supplied by CO.SI.ME. Repairs that affect explosion proof protection may only be carried out by CO.SI.ME



**6 Eliminazione / Riciclaggio** : L'eliminazione e riciclaggio del prodotto deve essere effettuata in accordo alle Norme nazionali in materia di rifiuti. ATTENZIONE : NON DISPERDERE L'APPARECCHIO ED I SUOI COMPONENTI NELL'AMBIENTE.

**6 Disposal / Recycling** : Disposal and recycling of the apparatus according to national regulations for waste disposal and recycling. WARNING : DO NOT DISPOSE THE APPARATUS AND HIS COMPONENTS IN THE ENVIROMENT.

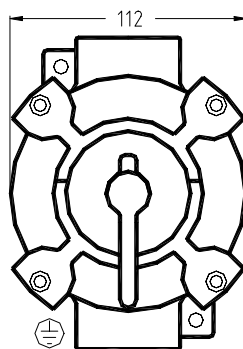
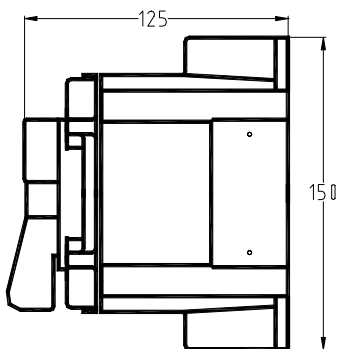

Temp. amb. +40°C Ambient temp. +40°C	Temp. amb. +60°C Ambient temp. +60°C	Temp. amb. +80°C Ambient temp. +80°C
Classe di temperatura Temperature class	Classe di temperatura Temperature class	Classe di temperatura Temperature class
T6 (T 80 °C)	T5 (T 95 °C)	T4 (T 130 °C)